

# Roller Blind 5-216

## MOTOR OPERATED ROLLER BLIND INSTALLED ON END BRACKETS L

### Description

- Heavy-duty powder coated steel brackets in white, grey or black
- Integrated leveling function to limit skewing
  - Optional no leveler
- Range of 230V motors depending on requirements
  - Force up to 37.5 kg
  - Noise standard or quiet
  - Wired control (recommended) or remote
- Spring loaded end plug with locking ring for safe use and easy maintenance
- Aluminium extruded tubes
- Aluminium extruded bottomrail in white, natural anodized or black
  - Optional oval shaped bottom rail
- Back or front rolling
- UV stable parts
- High quality fabric according to technical specifications

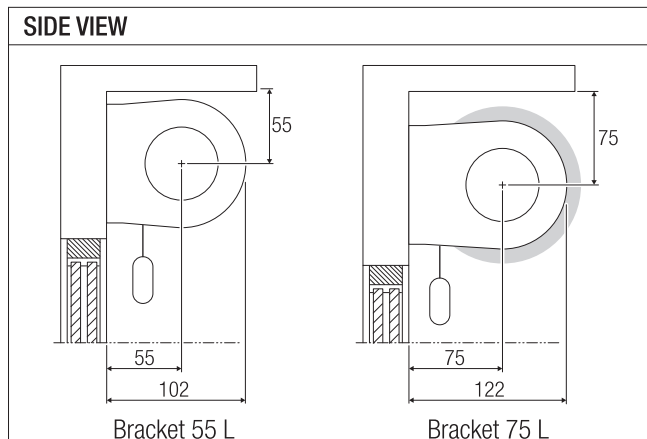
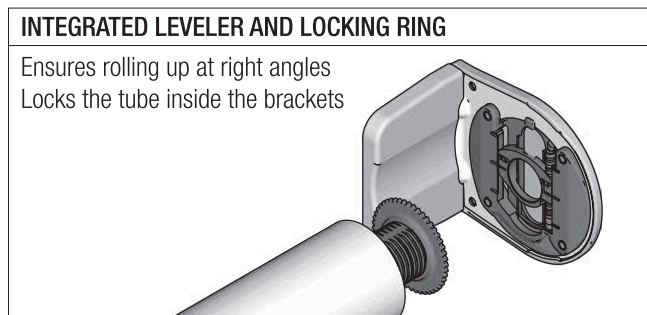
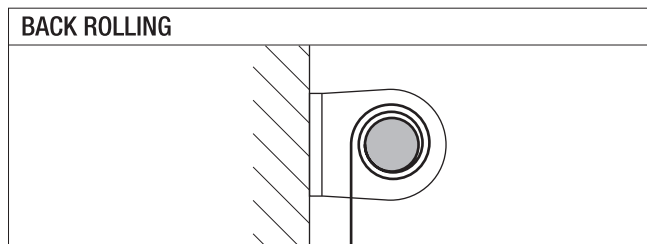
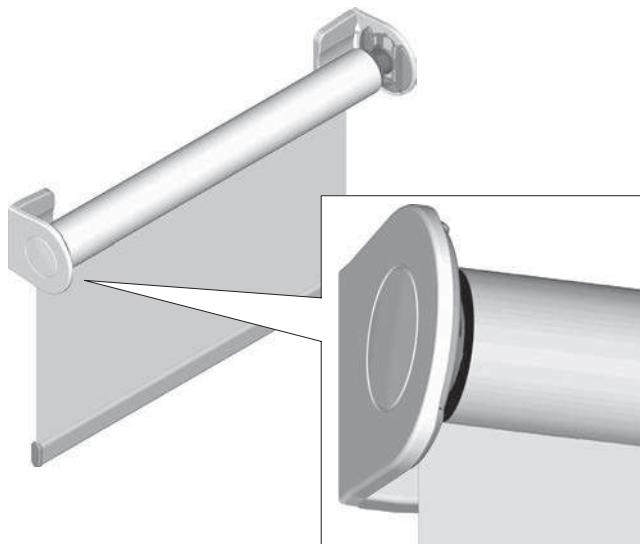

LIGHT GAPS (mm)		
Drive side		
Motor M40 and LS40	18	a
Motor M50	21	a
Motor LT50	28	a
Bearing side		
	23	b

SIZE LIMITATIONS*	
Min. width	575 - 675 mm (depending on motor size)
Max. width	4000 mm
Min. height	500 mm
Max. height	6000 mm
Max. surface	single blind; 16 m <sup>2</sup> coupled blinds; 48 m <sup>2</sup>

MAXIMUM LOAD (KG)*			
Type	U	Tube 50	Tube 62
Motor M40 and LS40	230 V	33.8	27.2
Motor M50 and LT50	230 V	37.5	30.3

*Maximum load = bottom rail + (optional) additional weight + fabric*

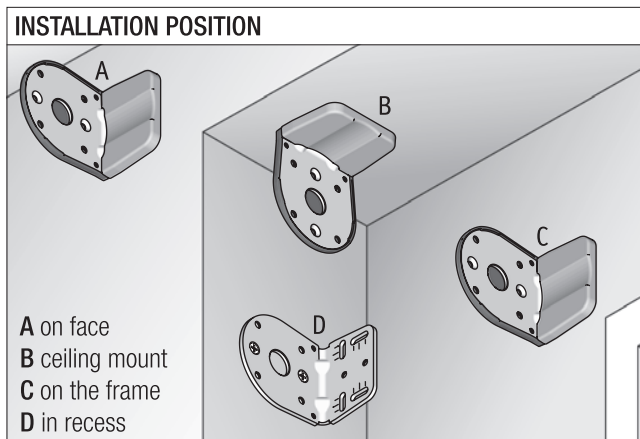

# OPTIONS Roller Blind 5-216

The technical terms on this page are clarified in the glossary in the back.

## LEVELER

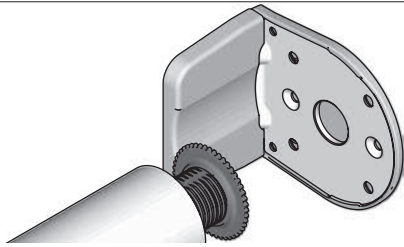

No leveler

### LIGHT GAPS (mm)

Drive side

Motor M40 and LS40	22	a
Motor M50	25	a
Motor LT50	28	a

Bearing side

Integrated leveler (std)	23	b
No leveler	19	b

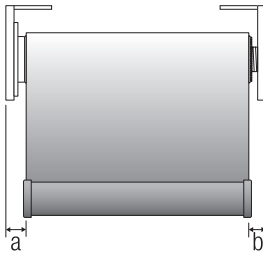

## FRONT ROLLING

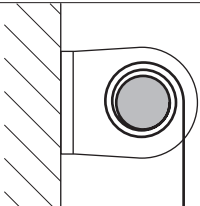

## COUPLING (see page 174)

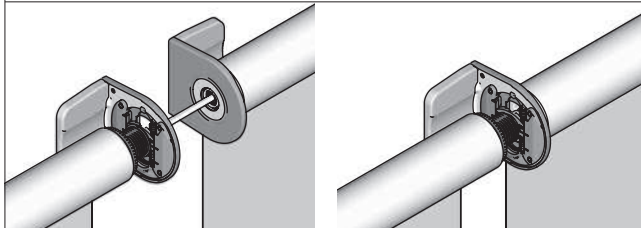

Straight coupling with aligner

Straight coupling

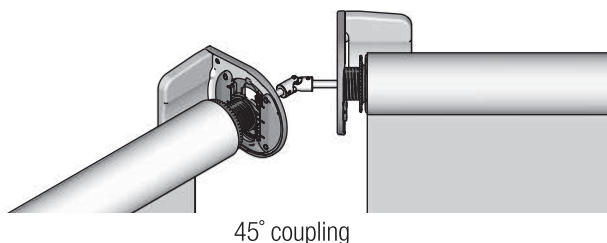

45° coupling

## OVAL BOTTOM RAIL

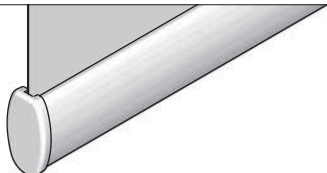

## SIDE GUIDING; SPRING TENSIONED CABLE

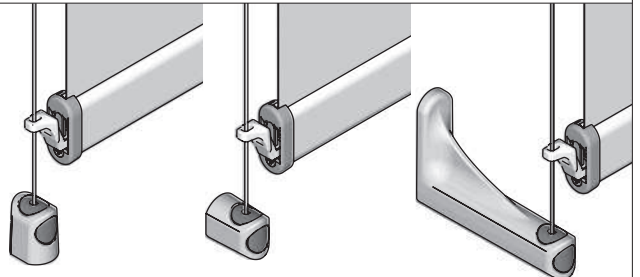

In recess

On face

On face, front rolling

### LIGHT GAPS (mm)

Drive side

Motor M40 and LS40	22	a
Motor M50	22	a
Motor LT50	28	a

Bearing side

Integrated leveler (std)	23	b
No leveler	22	b

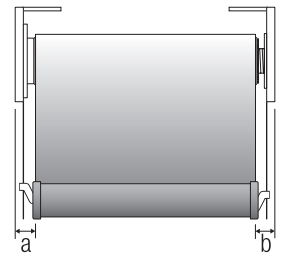

\*Size limitations and maximum load depend on operation type and are further calculated on the basis of a fabric with; weight = 345 gr/m<sup>2</sup>, thickness = 0.44 mm. Maximum deflection of tube 50 = 5 mm and tube 62 = 6 mm.